

ACTUATOR PED 2501



Specification :

Type	Variable Reluctance Servo
Angle of operation	25 ± 1 degree
Coil resistance	2 Ohms @ 12V and 4 Ohms @ 24V
Stall current	6 Amps at 12 V 4 Amps at 24 V
Operating current	3 Amps at 12 V 2 Amps at 24 V
Vibration level	20 G @ 20 - 2000 Hz
Response time	45 ms
Weight	Approx. 2 kg.
Insulation	H class dual coated
Operating temperature	- 40° C to 100° C
Torque	Approx. 1.5 pound-foot
Operating voltage	PED 2501 – 12V DC PED 2501A – 24V DC

Mounting informaton

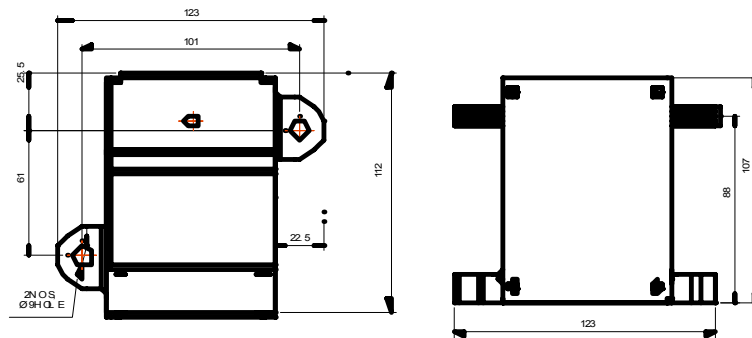

PRECISION ELECTRODYNAMICS

NO. 1/5, UNION CHAMBERS, OPP. APPOLLO TYRES LIMITED, NORTH KALAMASSERY,
ALAWYE, KERALA - 683104 • PHONE / FAX : (0484) 2551758